

Assembly Instruction Sheet #HS-20 21W9 For Style 2021W9

Total Required: 1 Redwood screwdriver, Phillips screwdriver, pliers, wire cutters, wire strippers, electrical tape, safety glasses.
Light Source: (1) E12 Candleless Bees Bulb 60W Medium(Bulb Not Included).
Individual Assembly Time: 16-30 minutes.

Preparation: Identify and inspect all parts before beginning installation. Check package content list and diagrams before to be sure all parts are present. If any parts are missing or damaged, do not attempt to assemble, install, or operate the fixture. Contact customer service for replacement parts.

⚠ Warnings and Cautions

Turn off electricity at circuit breaker or main fuse box before installation. Consult a licensed electrician if in doubt. These instructions are provided for your safety. It is very important you read them completely before installing the fixture. We strongly recommend that a licensed, professional electrician perform the installation. Disconnect fixture from power source before replacing bulbs. Make sure bulbs are given sufficient time to cool before removal.

Package Contents

- A** Backplate x1
- B** Arms x1
- C** Candle Cover X1
- 14mmx1PCS
50mmx1PCS
- 1** Crystal X4
- 14mmx4PCS
63mmx1PCS
2 Crystal X2

Hardware Contents

PART	DESCRIPTION	QUANTITY
BB	Wire nut	2pcs
CC	Outlet Box Screw	2pcs



STEP 1- Release Mounting bracket from Backplate.

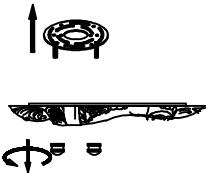

Figure 1

STEP 2 - Assemble the Arms to the Backplate.

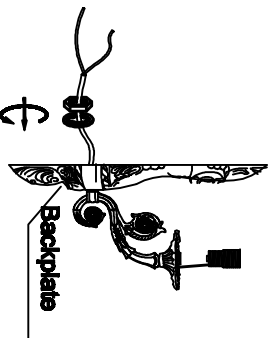

Figure 2

STEP 3 - Attach Mounting bracket to Outlet Box

A: Pass the supply wires through the Mounting bracket (EE).
 Attach the Mounting bracket (EE) to the Outlet Box with the head of the Green Ground Screw (CC) feeding you. Secure it with Outlet Box Screws. Tighten until snug.

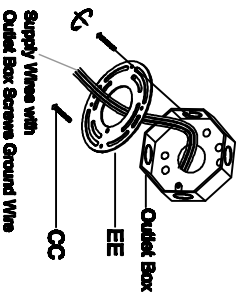

Figure 3

STEP 5 - Install Backplate to Ceiling

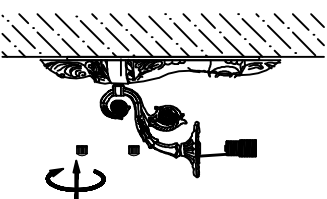

Figure 5

STEP 6 - Install crystal, candle covers and bulb.

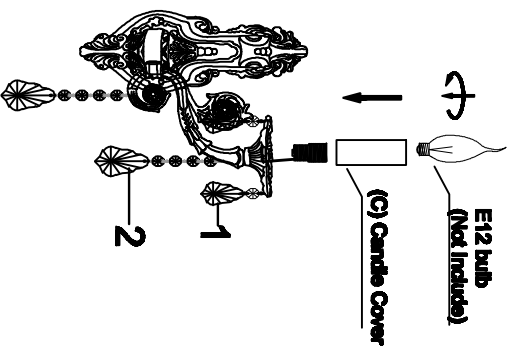

Figure 6

STEP 4 - Wire Connections
 Allow standard wire connections to make all the connections. Twist connectors until wires are snug. Jined together. Wrap each connection with approved electrical tape and carefully stuff all the connected wires into the Outlet Box.

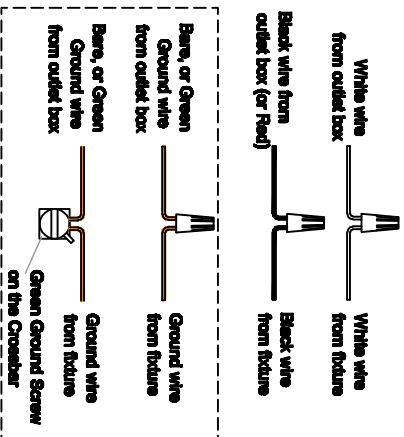

Figure 4